



INSTALLATION GUIDE



Karran USA
(866) 452-7726
info@karran.com



BATHROOM FAUCETS

The below instructions are a general installation guide to our Karran bathroom faucets. Your specific model may differ slightly from these steps shown here. Please refer to the model-specific installation guide that came with your new faucet. If we can be of additional assistance please contact us at 866-452-7726 or info@karran.com.

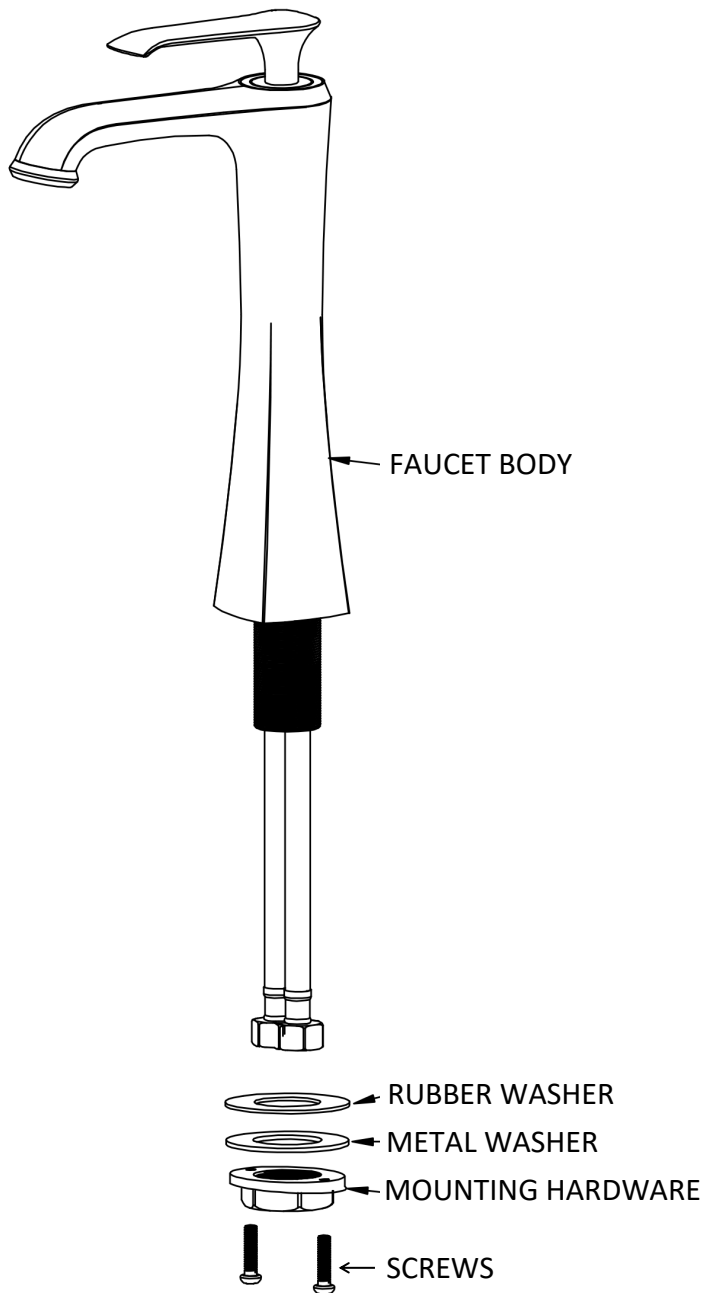

Step 1

Remove rubber washer, metal washer and mounting hardware from faucet body.

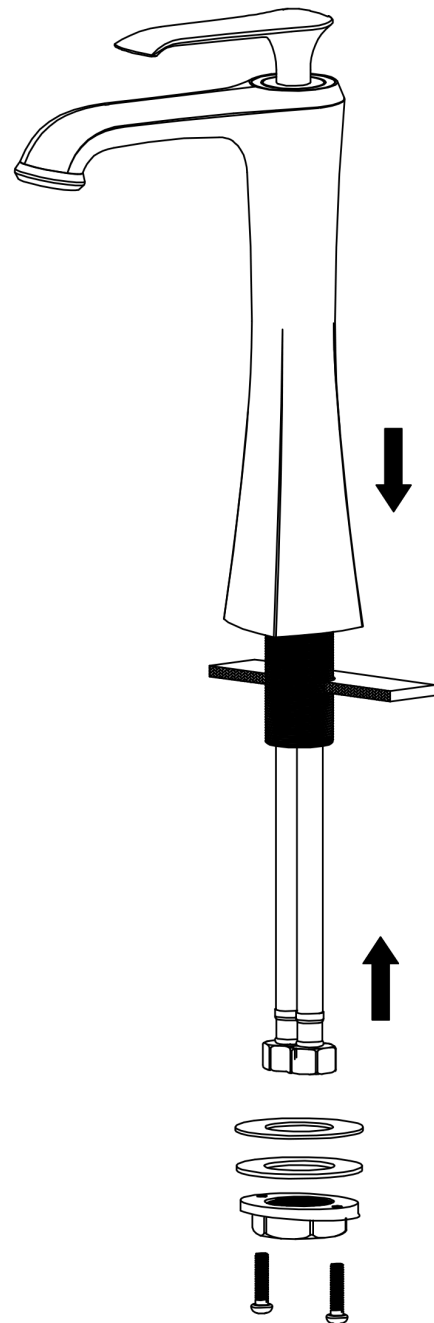

Step 2

Install faucet body through sink or countertop hole. Reinstall rubber washer, metal washer and mounting hardware from underside. Hand tighten mounting hardware then tighten screws with a screwdriver.

Operating instructions for your faucet

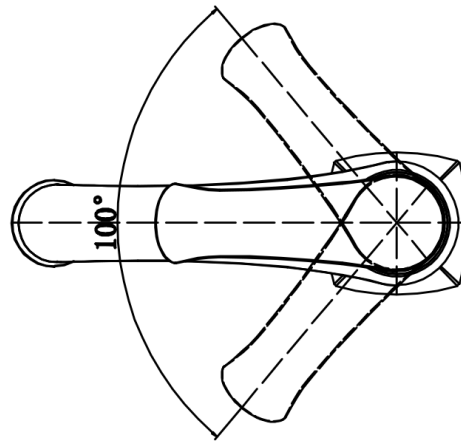
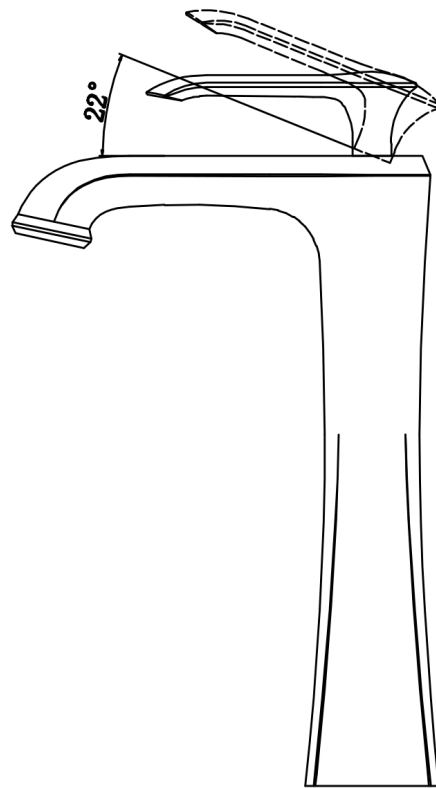

Lift the handle lever upward to turn the water on.

Turn the handle lever to the left to increase hot water flow with higher temperature

Turn the handle lever to the right to increase cold water flow with colder temperature